

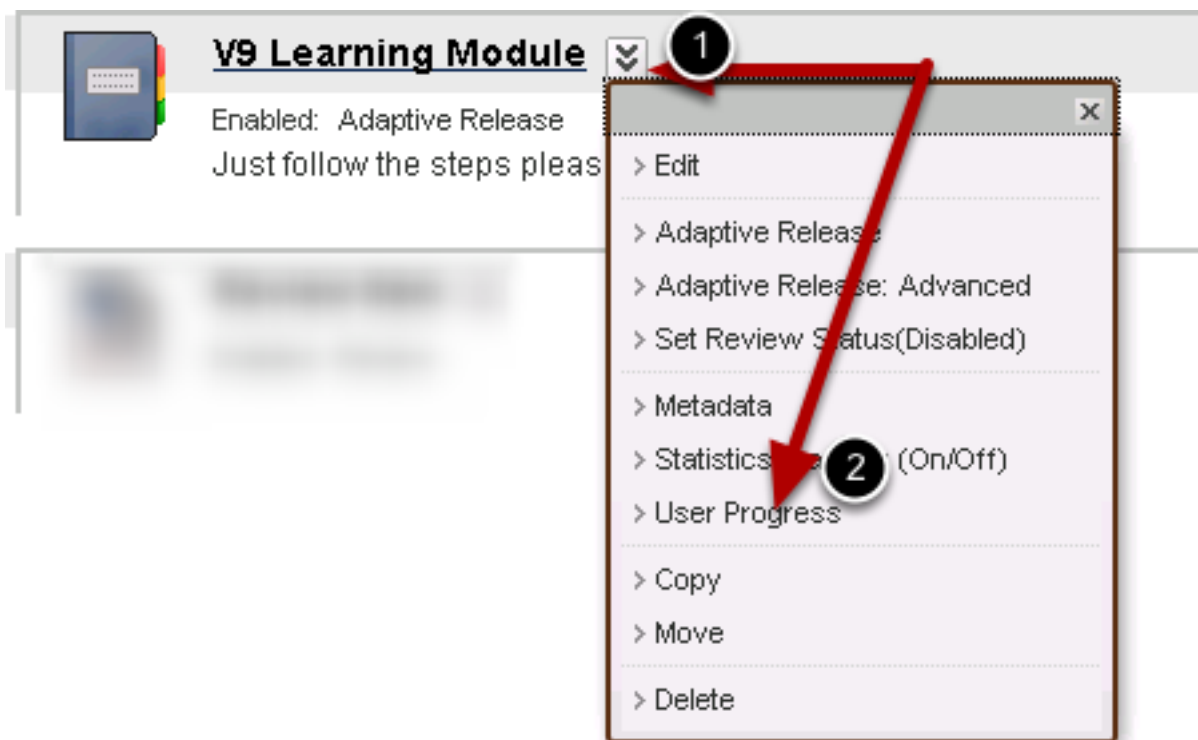

Adaptive Release - Basics: User Progress

This lesson shows you how to determine which users can or cannot see a given item.

Select Item To Verify



Find the item having the Adaptive Release Membership rule and click on the **Action Link** button, followed by **User Progress**.

User Progress Screen

Rule: [Rule 1](#) (Membership)

Last Name	First Name	Username	Course Role	Visibility
Smith				Visible
Naruponjirakul				
Vuthipadadorn				
McDonald				
Houston				
Russell				
Nishimoto				

On the **User Progress** screen, those users whom cannot see the item will show a closed eye with a red slash under the **Visibility** column. Students that can see the item will show an open eye indicator .