



## Adaptive Release - Basics: Based on Grade/Attempt

**Adaptive Release** gives instructors the opportunity to display content to individuals or groups in the class based on criteria set. Once the rule is created, each student has to meet the specific criteria before they are allowed to access the content.

Limiting availability based on grade/attempt requires the presence of two or more separate items. An example includes where students must have a score of 80% or greater on an assessment before the next section of reading material becomes available to them.

### Enable Edit Mode



First make sure that **Edit Mode** is **ON**.

### Find Item Where You Wish to Use Adaptive Release

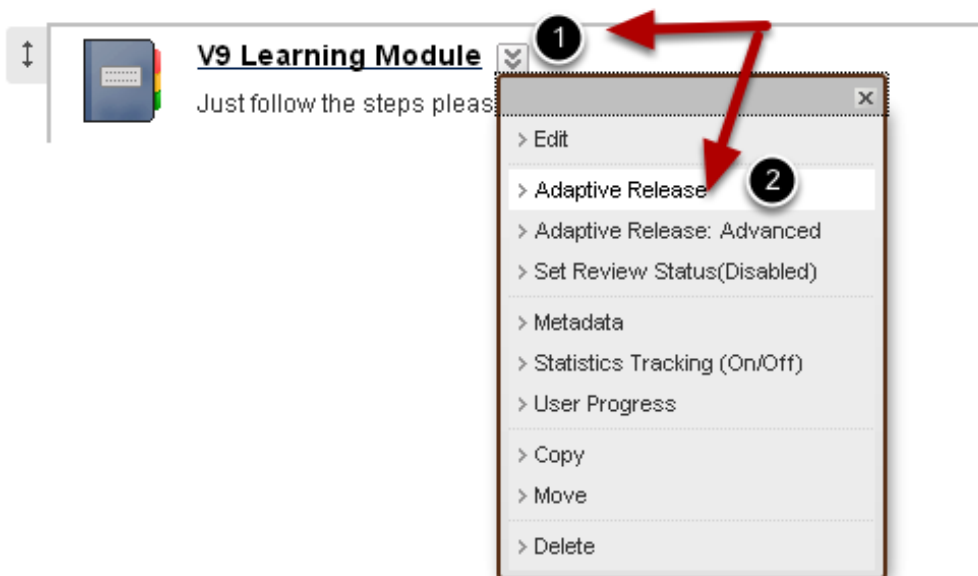

1. Click on that item's **Action Link** button .
2. Then, choose **Adaptive Release**.



## Select a Grade Center column

### 3. Grade

This content item is visible to all users until a Grade criterion is created. Possible points for a Grade Center grade or calculated column are listed in brackets beside the column name. The score entered must be numeric.

Select a Grade Center column

Select Condition

tempt for this item  
Grade Center when the user submits a Test, Survey, or Assignment, or when a grade is entered or edited.

Score  Percent Less than or equal to

Score  Percent Between  and

From the **Select a Grade Center column** dropdown menu, select a Grade Center Column that the rule will be based on. Assignments/exams are grouped alphabetically based on their column title. The total points possible is shown in brackets next to the column name.

## Select Condition

Select Condition

User has at least one attempt for this item  
An attempt is recorded in the Grade Center when the user submits a Test, Survey, or Assignment, or when a grade is entered or edited.

Score  Percent Less than or equal to

Score  Percent Less than or equal to  
 Score  Percent Greater than or equal to  
 Score  Percent Equal to

In the **Select Condition** section, select the desired criteria:

1. Selecting **User has at least one attempt for this item** will release the item after the student attempts a given assignment/assessment. An attempt is recorded in the Grade Center when a student submits the test, survey or assignment, or when a grade is entered or edited.
2. Selecting **Score** requires a matching criteria of *Less Than or Equal To*, *Greater Than or Equal To* or *Equal To*, and numerical score to be entered. The item will be released to the student if it matches that specific criteria.
3. The **Score Between** option requires a numerical high and low score to be entered. If the student receives a score between this, the item will be released to the student.



Submit

Cancel

Submit

Click **Submit** to accept the condition. Choose **Cancel** if you do not wish to keep the information.

Verify Rule Was Added

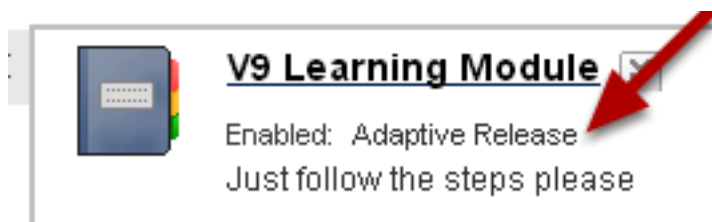

Verify that the words **Enabled: Adaptive Release** appear under the item name in the Edit View of that content area.

**NOTE:** If **Date** and **Membership** criteria have been selected, conditional grade release will co-exist with these criteria, meaning that **students must satisfy all criteria** in order for the item to be available to them.